



23 Longford Drive, Bradway, Sheffield, S17 4LN

Saxton Mee



# 23 Longford Drive

## Bradway

Asking Price

**£375,000**

A traditional three bedroom semi detached family home offering spacious rooms throughout and a good size driveway with detached garage.

This lovely family home is being offered for sale for the first time since new and is offered for sale with NO ONWARD CHAIN. Having been lovingly maintained over the years this delightful property would suit a young family looking for their first home.

This spacious home briefly comprises: Good size entrance hall with cloak cupboard, lounge with feature fireplace and bay window, separate dining room with bay overlooking the lovely back garden and a kitchen with larder and separate storage cupboard.

The first floor offers two good size double bedrooms each having a bay window, a great size single bedroom with storage and oriel window, a shower room with shower cubicle, wash hand basin and a separate w.c.

Externally this delightful property has a foregarden and a driveway providing plenty of off road parking and access to the detached single garage, which has power and light. To the rear of the property is a seating area, lawn area and a there is a range of mature shrubs and trees.

This delightful property is well worthy of an internal inspection, book your viewing today!



- NO CHAIN
- Semi Detached With Three Spacious Bedrooms
- Space To Extend (Subject To Necessary Consents)
- Two Reception Rooms
- Detached Garage And Plenty Of Off Road Parking
- Lovely Rear Garden
- Double Glazed And Gas Central Heated
- Located Close To Excellent Amenities And Schools
- Short Distance To Peak District National Park
- Council Tax Band C/EPC Rating D/Freehold







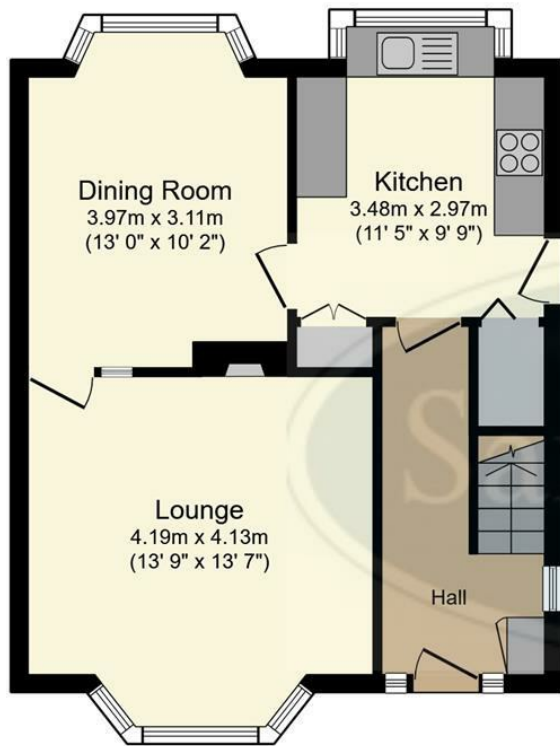

**Ground Floor**  
Floor area 47.5 m<sup>2</sup> (511 sq.ft.)



**First Floor**  
Floor area 47.0 m<sup>2</sup> (506 sq.ft.)

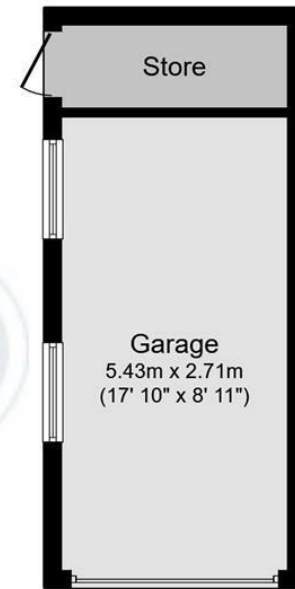

**Garage**  
Floor area 17.7 m<sup>2</sup>  
(190 sq.ft.)

**TOTAL: 112.2 m<sup>2</sup> (1,207 sq.ft.)**

This floor plan is for illustrative purposes only. It is not drawn to scale. Any measurements, floor areas (including any total floor area), openings and orientations are approximate. No details are guaranteed, they cannot be relied upon for any purpose and do not form any part of any agreement. No liability is taken for any error, omission or misstatement. A party must rely upon its own inspection(s). Powered by [www.Propertybox.io](http://www.Propertybox.io)

While we endeavour to make our sales particulars fair, accurate and reliable, they are only a general guide to the property and, accordingly, if there is any point, which is of particular importance to you, please contact the relevant office. The Agents have not tested any apparatus, equipment, fittings or services and so cannot verify they are in working order. The buyer is advised to obtain verification. Please note all the measurement details are approximate and should not be relied upon as exact. All plans, floor plans and maps are for guidance purposes only and are not to scale. Under no circumstances should they be relied upon as exact or for use in planning carpets and other such fixtures, fittings or furnishings. YOUR HOME IS AT RISK IF YOU DO NOT KEEP UP REPAYMENTS ON A MORTGAGE OR OTHER LOAN SECURED ON IT. 'A Life Assurance policy may be requested.' 'Written Quotations of credit terms available on request.'

**Banner Cross**  
T: 0114 268 3241  
E: [bannercross@saxtonmee.co.uk](mailto:bannercross@saxtonmee.co.uk)  
[www.saxtonmee.co.uk](http://www.saxtonmee.co.uk)

**Hathersage**  
T: 01433 650009  
E: [hathersage@saxtonmee.co.uk](mailto:hathersage@saxtonmee.co.uk)

**Bakewell**  
T: 01629 815307  
E: [bakewell@saxtonmee.co.uk](mailto:bakewell@saxtonmee.co.uk)

**Matlock**  
T: 01629 828250  
E: [matlock@saxtonmee.co.uk](mailto:matlock@saxtonmee.co.uk)

